



EXTERIOR  
DECKING



# GARDEN ART & DESIGN

Coming together with the  
worlds best **decking** system

-exterpark®

the magnet®  
DECKING REINVENTED  
by -exterpark





GARDEN ART & DESIGN COMING TOGETHER

GARDEN ART & DESIGN COMING TOGETHER



PROJECT - EXTERPARK MAGNET CUBE COMPOSITE



GARDEN ART & DESIGN COMING TOGETHER

GARDEN ART & DESIGN COMING TOGETHER



PROJECT - ACCOYA® TREATED WITH





GARDEN ART & DESIGN COMING TOGETHER



PROJECT - EXTERPARK MAGNET KEBONY®

GARDEN ART & DESIGN COMING TOGETHER

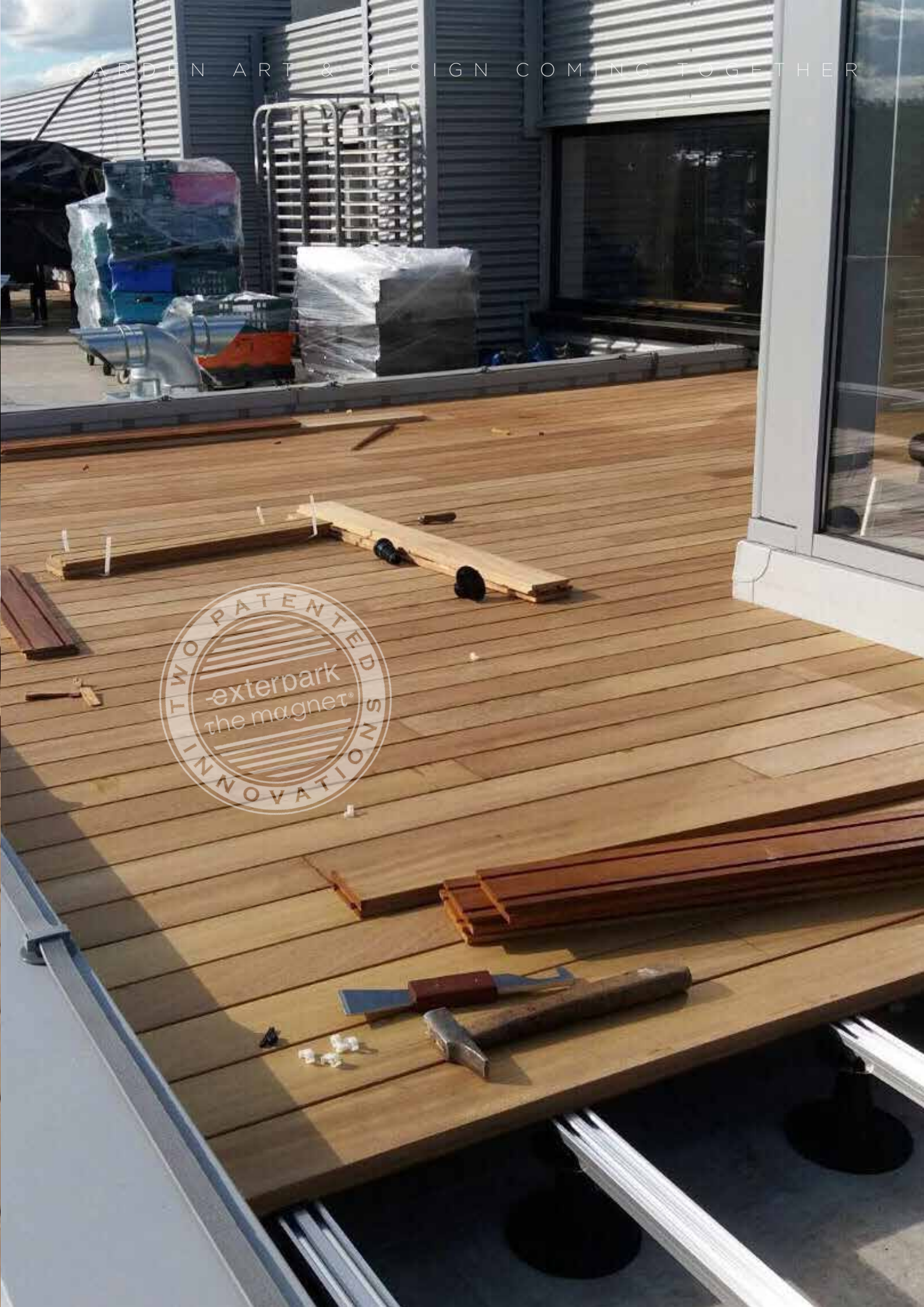



GARDEN ART & DESIGN COMING TOGETHER

GARDEN ART & DESIGN COMING TOGETHER

# WHO WE ARE

Our Company, Yvyra, manufactures indoor and outdoor wood floors for 45 years with a firm commitment to:

QUALITY RELIABILITY INNOVATION

Our floors have been embraced in all kinds of projects in more than 60 countries worldwide, featuring collaborations with internationally known architects such as Frank Gehry, Jean Nouvel, Santiago Calatrava and Norman Foster.

R+D+I TRADITION EXPERIENCE KNOW-HOW

Stimulates us to improve our products and find better solutions to be one step ahead.

1995

We invented and patented the first hidden fastening system clip for decks, named Exterpark Classic.

This has become today the standard fixing system for most producers worldwide. **No more screws on the surface.**

2004

Our profile evolved with a subtle modification. The invisible profile for decking was born and patented.

The understructure was not visible, loss of valuables was no longer a concern and our decks became safer and cleaner for the users.

2012

Was the launching of our third patented innovation. SpeedClip was our first contribution to making installation easier, screw-less, definitely faster and cost-efficient.

2014

Our best creation arrived in late 2014. The Magnet is the best system we have ever developed. A system that works for virtually any kind of surface featuring multiple virtues:



# EASY

VERSATILITY

REUSABILITY

TOTAL  
ACCESSIBILITY



exterpark®

the magnet®  
DECKING REINVENTED  
by exterpark



Distributed by **Exterior Solutions Ltd.**  
Showroom at The Sky House Design Centre.  
Design by Decorum.London

Innovation award 2016  
**Innovations@DOMOTEX**

Recognition to innovation,  
sustainability and design 2017  
**Barcelona Building Construmat**

supervised by:  
**fundació mies van der rohe barcelona**



# NO SCREWS



## exterpark INVISIBLE PROFILE

STANDARD PROFILE WITH OPEN GAPS Vs EXTERPARK INVISIBLE PROFILE

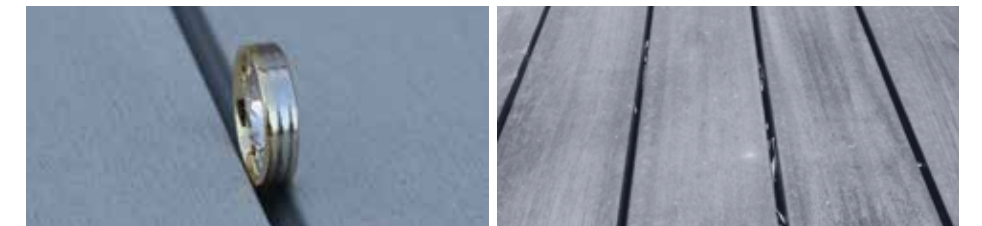

Our Invisible patented profile provides:

Better Look: no gaps and no visible understructure

Hygienic: no food or other objects can fall down

No loss of valuables: coins, rings or keys

Safer: nothing can get stuck such as high heels or fingers

## the magnet® ASSEMBLY

INSTALLATION BENEFITS

An advanced mechanical locking with superior grip which holds boards stronger than a screw but yet flexible to open up and close again if necessary



**EASY** No screw    **FAST** No predrilling    **SILENT** No tools

## COST-EFFECTIVE



GARDEN ART & DESIGN COMING TOGETHER

GARDEN ART & DESIGN COMING TOGETHER

the magnet®

## ACCESSIBILITY

TOTAL ACCESS FOR DECKS AND WALLS

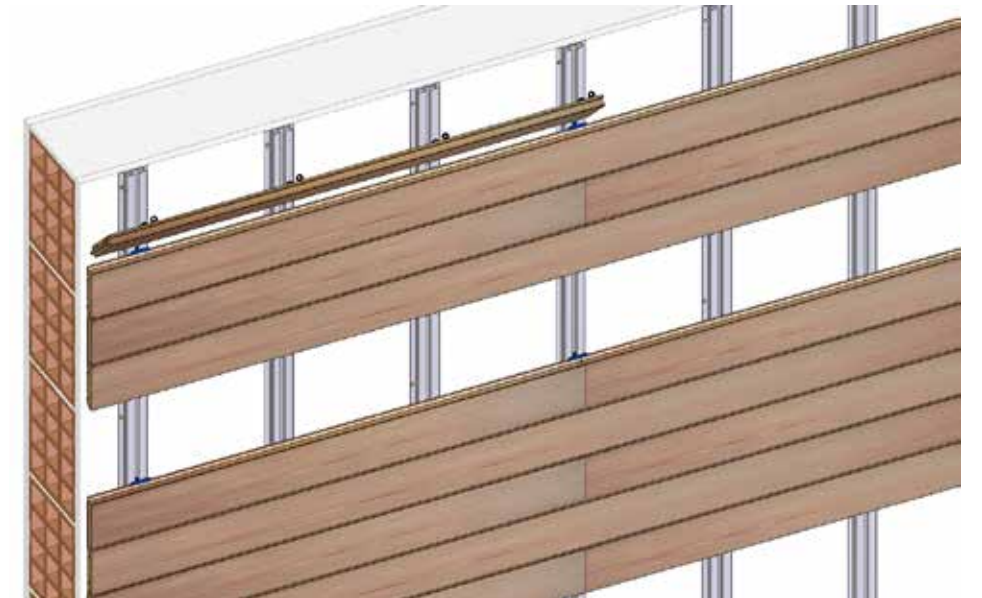

CREATIVE





the magnet®

## UNIQUE CLIP AND JOISTS

THE MAGNET SYSTEM WORKS OVER 6 ESSENTIAL ELEMENTS:

- 1 A special groove at the bottom of each board to allocate magnet clips
- 2 Aluminum joists with a very specific and accurate geometry for the magnet clip to click inside
- 3 Spacers between boards to leave 4mm invisible expansion and drainage gap
- 4 Blocking units to keep all boards always in same place and prevent longitudinal movement
- 5 Levelling instruments such as pedestals and wedges

A COMPLETE SYSTEM  
the magnet®

The Magnet clip is the corner stone of the system. The key is the strength with the right flexibility. Fully made of POM, a high performance engineering thermoplastic with excellent dimensional stability even at extreme conditions. Strong yet flexible, low friction coefficient and high abrasion resistance.



## SOLID ALUMINIUM JOISTS

ALL SCENARIOS - BUILDING IT FOREVER

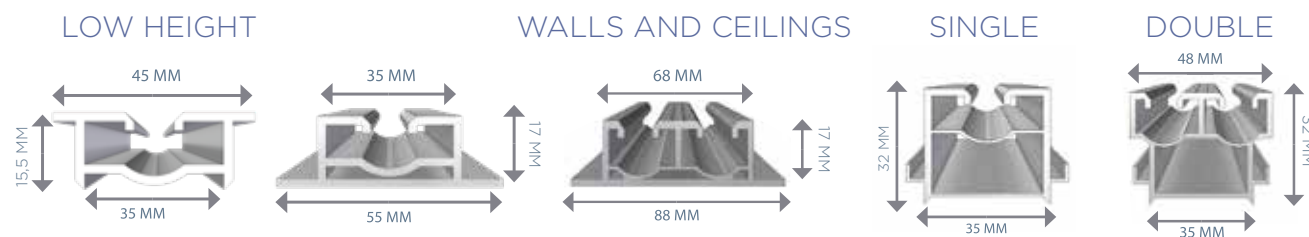

Exterpark Tech Plus patented invisible profile with no gaps Vs 6mm gap current specification. Our Invisible profile provides several advantages Vs traditional open gaps:

## BENEFITS OF THE SYSTEM

- Improved loading capacity to more than 4000kgs per m2
- Superior mechanical properties to hold clips
- Upgraded Stability: will remain straight, it won't warp nor decay
- Enlarged service life
- Save costs and time by using less pedestals every 50 or 60cm
- Fixed lengths of 2200mm

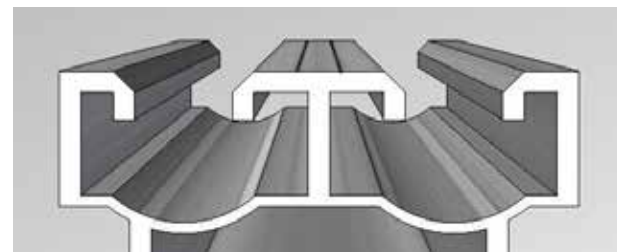

We have created the double click joist for the short-end connections, which is a must for the good performance of the product. There is even a 4mm spacing mark for the indicative recommended expansion gap essential for Exterpark Tech.

the magnet®

## COMPREHENSIVE SYSTEM

INSTRUMENTS

## Levelling wedges

and height adjustable pedestals.



## Blocking spacer

to prevent longitudinal misplacement of boards and still allow for the required expansion and contraction.

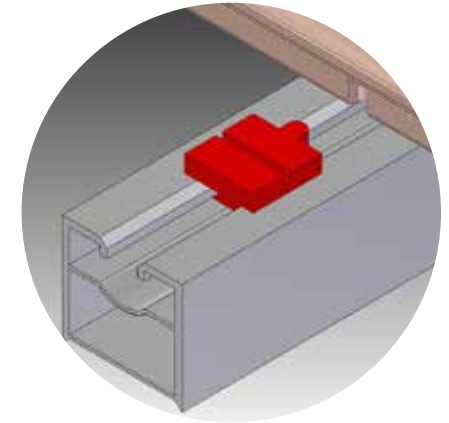

**Cross Joists** ensure your joist centers are exact and add to your substructures stability. Available in span sizes – 400, 366 and 300mm.



**Pointed joist leg** interlocks perfectly with wedges for a very easy and accurate levelling.

**Using the magnet tool**, any board can be opened up in less than 5 seconds



CPD

CONTINUOUS PROFESSIONAL DEVELOPMENT



HELPING  
YOU

Book your CPD now  
[jane@exterior.supplies](mailto:jane@exterior.supplies)

HARDWOOD CLADDING

SUB HEADING/DESCRIPTION HERE



Accoya



Kebony



Ipe



Thermo Ash



Bamboo



Teak



Iroko

HARDWOOD CLADDING

SUB HEADING/DESCRIPTION HERE



Antique



Bronze



Teka



Ipe



GARDEN ART & DESIGN COMING TOGETHER

# HOME & GARDEN



MAGNET COMPOSITE DECKING

GARDEN ART & DESIGN COMING TOGETHER

# POOLSIDE





GARDEN ART & DESIGN COMING TOGETHER

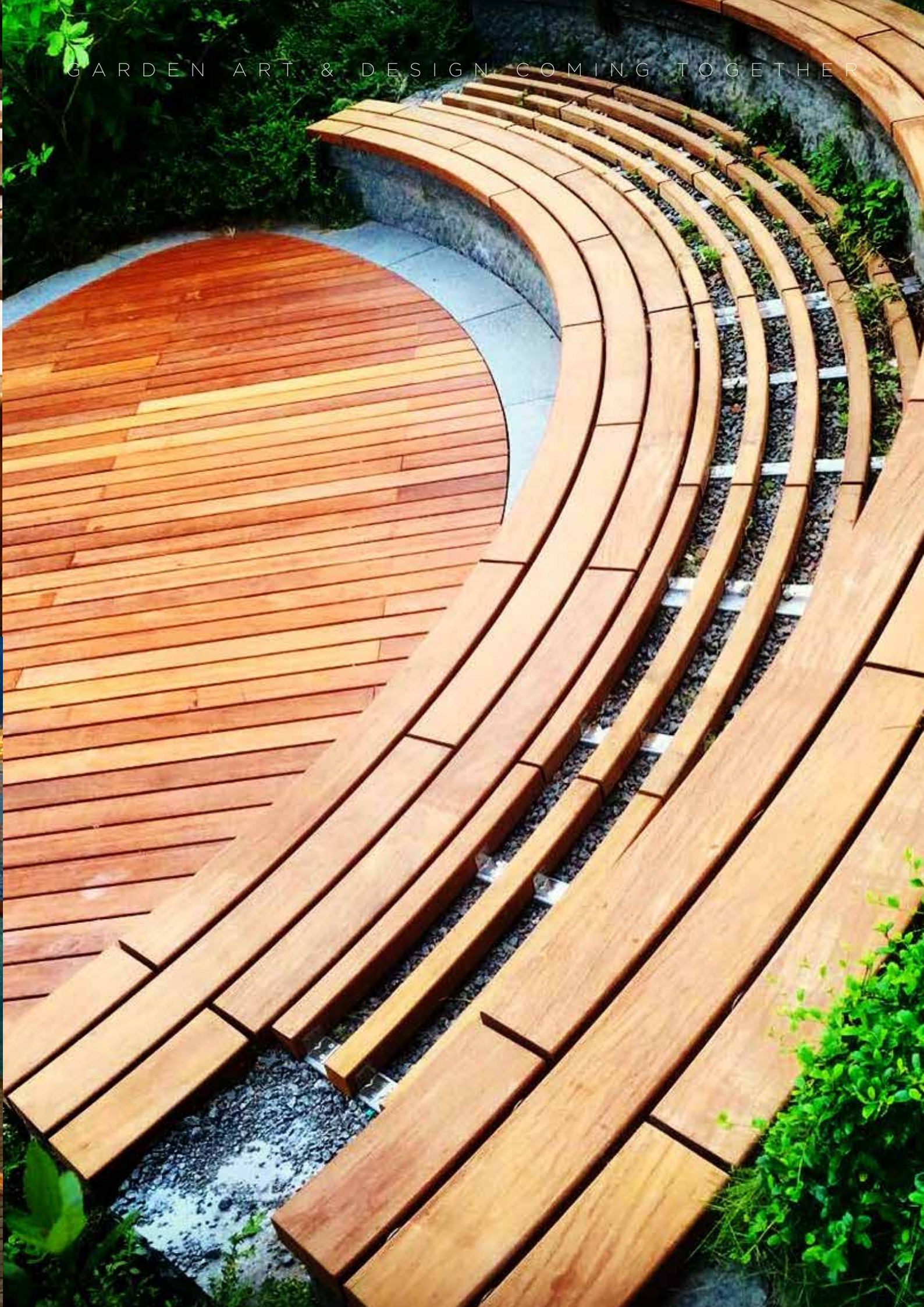

GARDEN ART & DESIGN COMING TOGETHER



MAGNET REAL WOOD DECKING



GARDEN ART & DESIGN COMING TOGETHER

# BUSINESS



MAGNET REAL WOOD DECKING

GARDEN ART & DESIGN COMING TOGETHER

# RESTAURANT





GARDEN, ART & DESIGN COMING TOGETHER



EXTERIOR  
SOLUTIONS

**01494 711 800**

[sales@exterior.supplies](mailto:sales@exterior.supplies)

Sky House Design Centre,  
Raans Rd, Amersham, HP6 6JQ

[www.exterior.supplies](http://www.exterior.supplies)



**FUTURE  
SPACE**